



Project: St Michael Catholic School Ridgetown
Childcare Retrofit & Office Renovations
25 Maple Street
Ridgetown, Ontario

Project ID: ROA15-008
Client No.: 640-CP1502
Addendum: 3

Attention: Project Bidders

Date: April 15, 2015

This Addendum is hereby made a part of the Contract Documents and modifies the original Bidding Documents as noted below. The following additions, deletions and amendments shall be incorporated into the bid submission.

3.1 DRAWING

3.1.1 Refer to attached Drawing SK101

- .1 Relocation of door 104.
- .2 Relocation and re-configuration of exterior sidewalk and associated grading.
- .3 Refer to detail 3 on SK101 New Frame type 'D' for relocated door 104.

END OF ADDENDUM #3

PREPARED BY THE CONSULTANT

Joseph Ouellette | Principal

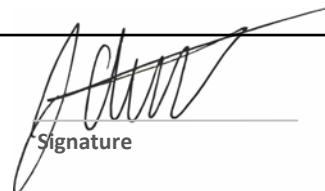

Signature

04.15.2015

Date: MM.DD.YEAR



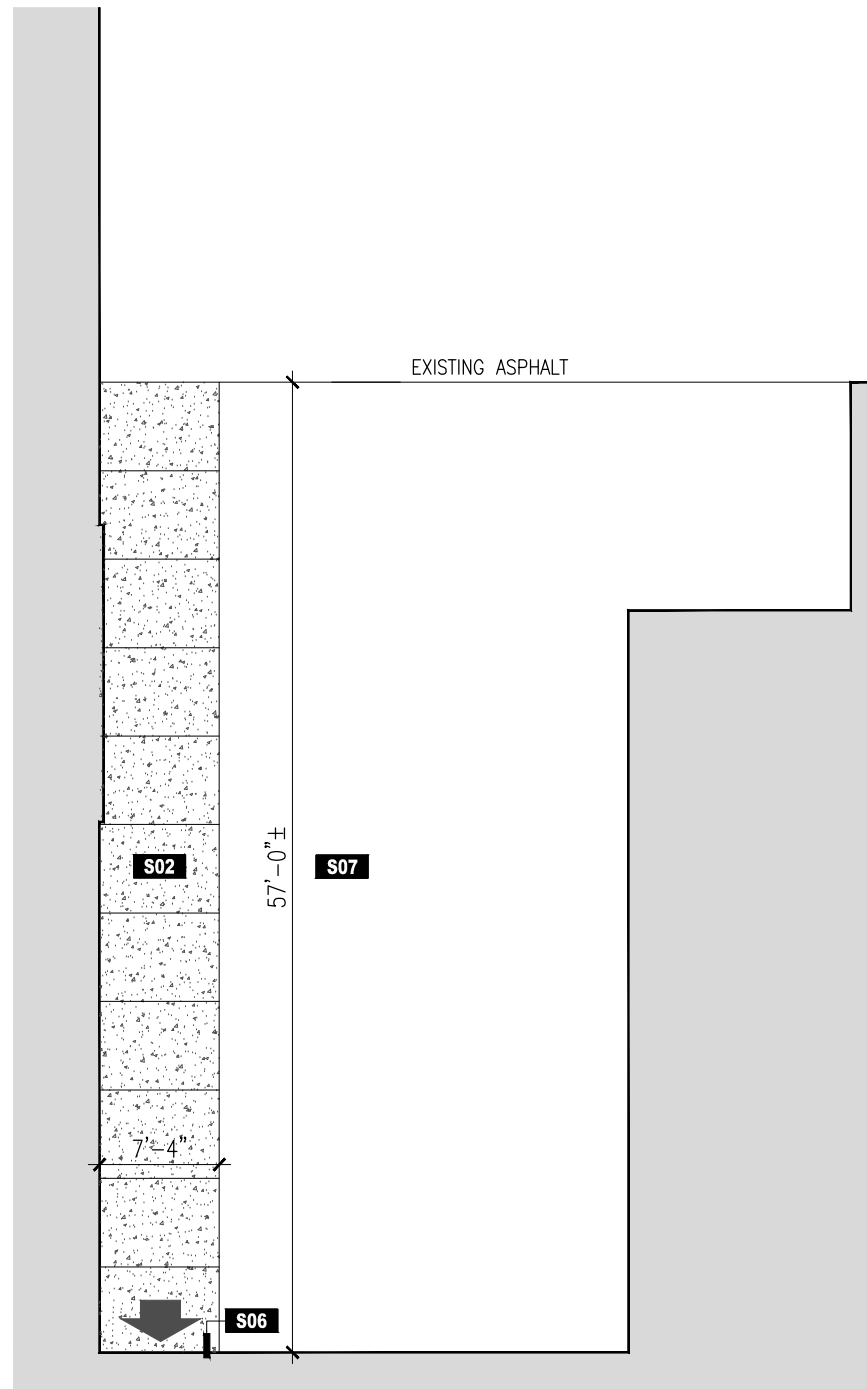

01 PARTIAL SITE PLAN - BACK COURTYARD
 SK101 SCALE: 3/32" = 1'-0"

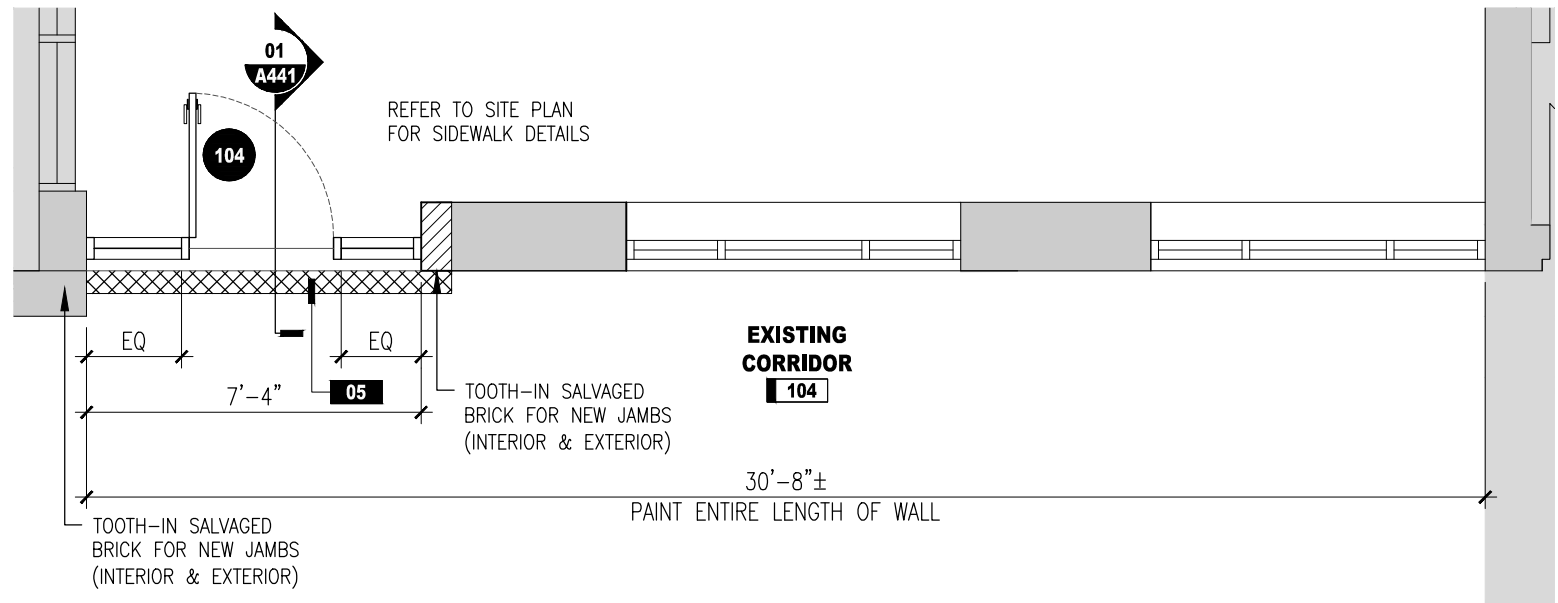

02 PARTIAL FLOOR PLAN - CORRIDOR 104
 SK101 SCALE: 1/4" = 1'-0"

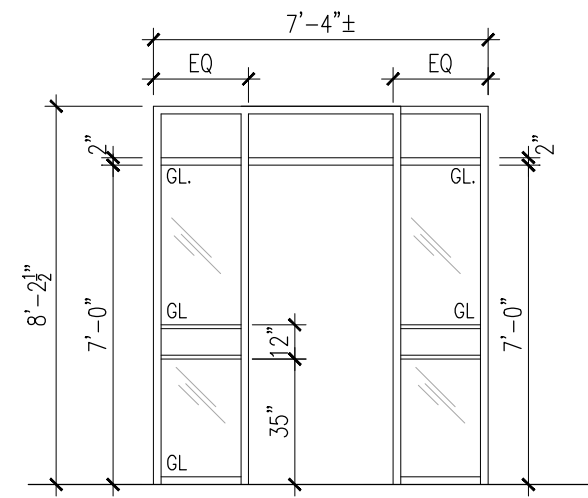

FRAME TYPE 'D'
 NOTE:
 ALUM FRAMING BASED ON KAWNEER 451

03 NEW FRAME TYPE "D"
 SK101 SCALE: 3/32" = 1'-0"

GENERAL NOTES

THE CONTRACTOR SHALL CHECK AND VERIFY ALL DIMENSIONS AND REPORT ANY ERRORS OR OMISSIONS TO THE ARCHITECT PRIOR TO COMMENCING OR PROCEEDING WITH ANY WORK ON THIS PROJECT. ALL DRAWINGS AND SPECIFICATIONS ARE THE PROPERTY OF THE ARCHITECT COPYRIGHT 2014. THESE DRAWINGS AND SPECIFICATIONS ARE DESIGNED FOR THE CLIENT AND THE PROPERTY INDICATED ON THESE DRAWINGS ONLY AND SHALL NOT BE CONSTRUCTED FOR ANY OTHER CLIENT OR ANY OTHER PROPERTY. DO NOT SCALE DRAWINGS.

PROJECT INFORMATION

ST. MICHAEL CATHOLIC SCHOOL RIDGETOWN
CHILDCARE RETROFIT & OFFICE RENOVATIONS

25 MAPLE STREET
 RIDGETOWN, ONTARIO

DRAWING INFORMATION

REVISED DOOR & FRAME CORRIDOR 104 & SIDEWALK REVISIONS

PRIME CONSULTANT

ROA studio inc.
 67 King Street West, Chatham ON N7M 1C7
 tel. 519.397.0943
 email. info@roastudio.com

DISCIPLINE SEAL

DRAWING SUBMISSION

NO.	DESCRIPTION	DATE MM-DD-YY
1	ISSUED FOR ADDENDUM #3	04-14-15

INTERNAL INFO

ARCHITECTURE

PROJECT ID: ROA15-008
 DRAWN BY: J. OUELLETTE
 REVIEWED BY: J. OUELLETTE
 DATE: 04.14.2015
 SCALE: AS NOTED

COPYRIGHT 2015

DRAWING No. SK101